

Office to let

Sema Office - Bruxelles Building

Bucharest, Sector 6, 319 Splaiul Independentei



Building information

Building status	Existing
Year of construction	2016
Parking ratio	1 / 50 sq m
Total building area	13 488 sq m

Commercial terms

Office space*	after login *
Parking	after login *
Service charge*	after login *
Minimum lease term	after login *
Availability	after login *

* Asking terms for m²/month

Location

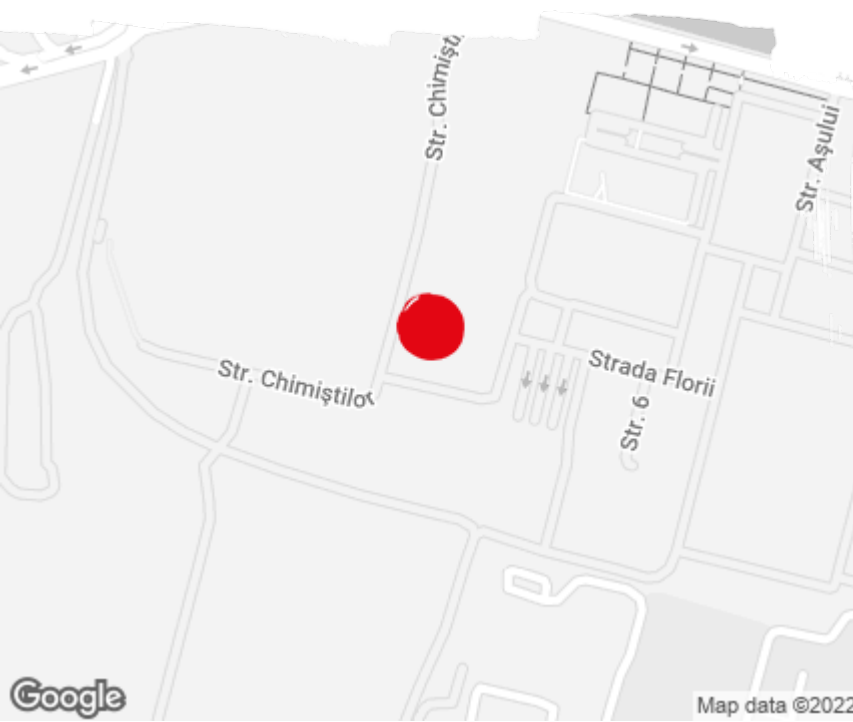

Available space

1 628 sq m

Available office space

750 sq m

Minimum office space

Typical floor plan

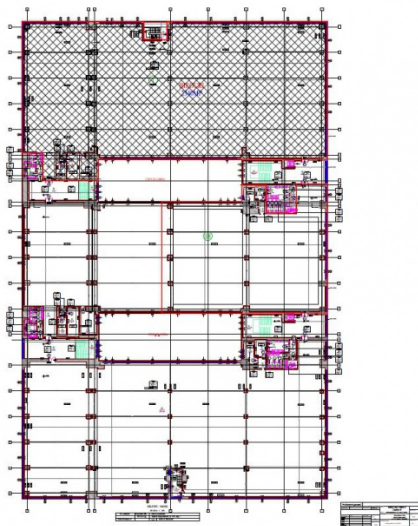

Available space

Floor	Vacant space	Availability
0	please contact us *	please contact us *
1	please contact us *	please contact us *
Total	after login *	

Public transport

Metro: M1
Bus: 201, N110
Tram: 41

Contact

+40 21 302 3400
More information